

REGIONAL TRANSIT ISSUE PAPER

Agenda Item No.	Board Meeting Date	Open/Closed Session	Information/Action Item	Issue Date
3	03/09/15	Open	Action	03/02/15

Subject: Approving Easement Agreement with Pacific Gas and Electric Company for installation and maintenance of Gas Improvements

ISSUE

Whether to approve an Easement Agreement with Pacific Gas and Electric Company to install gas improvements.

RECOMMENDED ACTION

Adopt Resolution No. 15-03-_____, Approving an Easement Agreement with the Pacific Gas and Electric Company to Install Gas Utilities within Sacramento Regional Transit District's (RT) Right of Way at 10th Street.

FISCAL IMPACT

None.

DISCUSSION

The subject property is located within RT's right of way at 10th Street in the City of Sacramento and is further identified in Attachment A (APN: 006-0274-013).

Adjacent property owner RII Properties LLC requested that the Pacific Gas and Electric Company (PG&E) install gas utilities to the W.P. Fuller Building located at 1015 R Street. PG&E has requested an easement interest in RT's right of way to install utilities to serve the W.P. Fuller Building. PG&E has requested a 20' wide easement to install and maintain a 1" gas service pipe approximately 40' in length perpendicular to the tracks and 24' in length parallel to the tracks.

RT purchased this property as part of the Q/R Alley Track Project for the construction, maintenance and operation of railroad trackage. This is a non-operable rail segment mainly used for storage. RT Engineering and Construction Staff have reviewed and approved the plans for installation of the gas service pipe. The easement interest granted will be in perpetuity. RT will not charge PG&E for the property interest, but will charge fees incurred by staff to review construction plans and provide inspection services.

Staff recommends approval of the Easement Agreement between RT and PG&E for installation of gas utilities within RT's right of way.

Approved:

Presented:

Final 03/03/15

General Manager/CEO

Real Estate Administrator

J:\Real Estate\Issue Papers\2015 Issue Papers\Approving an Easement Agreement with PG&E.doc

CONSTRUCTION NOTES

APPLICANT TO:
PROVIDE ALL TRENCHING, HAVE SAND ON SITE @ TIME OF TRENCH INSPECTION.

PG&E TO:
INSTALL 1" PLASTIC SERVICE
TIE-IN @ EXIST 1 1/4" PL MAIN
SET 1 1/4" RISER W/BY-PASS
INSTALL 1" CURB VALVE IN FULL TRAFFIC FRAME & COVER
1984 1 1/4" PL MAIN IS TR-418

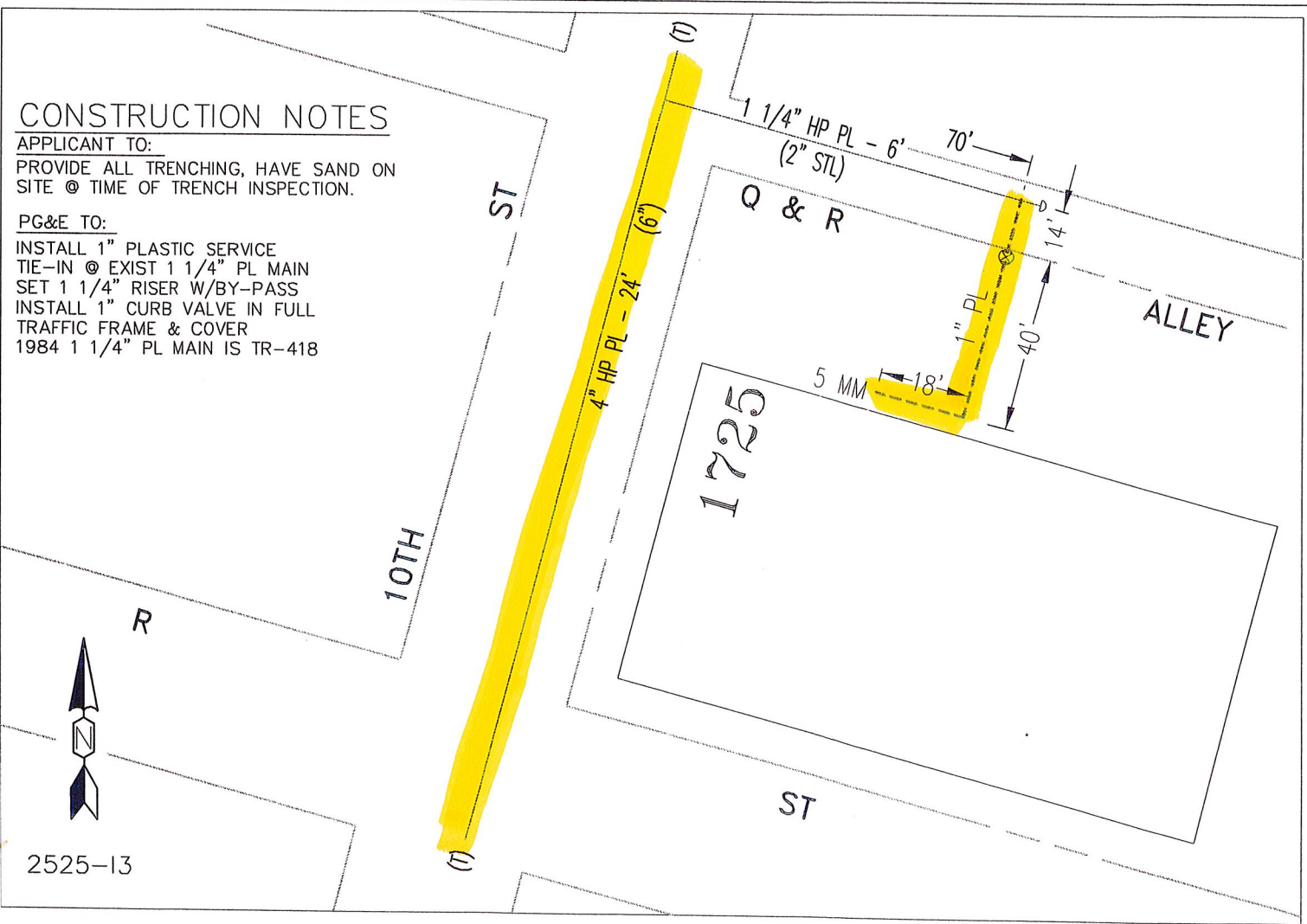

RESOLUTION NO. 15-03-_____

Adopted by the Board of Directors of the Sacramento Regional Transit District on this date:

March 9, 2015

APPROVING AN EASEMENT AGREEMENT WITH THE PACIFIC GAS AND ELECTRIC COMPANY TO INSTALL GAS UTILITIES WITHIN SACRAMENTO REGIONAL TRANSIT DISTRICT'S (RT) RIGHT OF WAY AT 10th STREET

BE IT HEREBY RESOLVED BY THE BOARD OF DIRECTORS OF THE SACRAMENTO REGIONAL TRANSIT DISTRICT AS FOLLOWS:

THAT, the Easement Agreement between the Sacramento Regional Transit District, therein referred to as "RT," and Pacific Gas and Electric Company, therein referred to as "PG&E," whereby RT grants PG&E a non-exclusive 20' wide easement in gross for the purpose of installing and maintaining a 1" gas service pipe and connections for a distance of 40'+/- perpendicular to RT tracks and a minimum of 6' under RT's tracks and for a distance of 24'+/- parallel to RT's tracks, is hereby approved.

THAT, the General Manager/CEO is hereby authorized and directed to execute said Easement Agreement.

JAY SCHENIRER, Chair

A T T E S T:

MICHAEL R. WILEY, Secretary

By: _____
Cindy Brooks, Assistant Secretary